

## Employment Supported by Highway and Bridge Investment

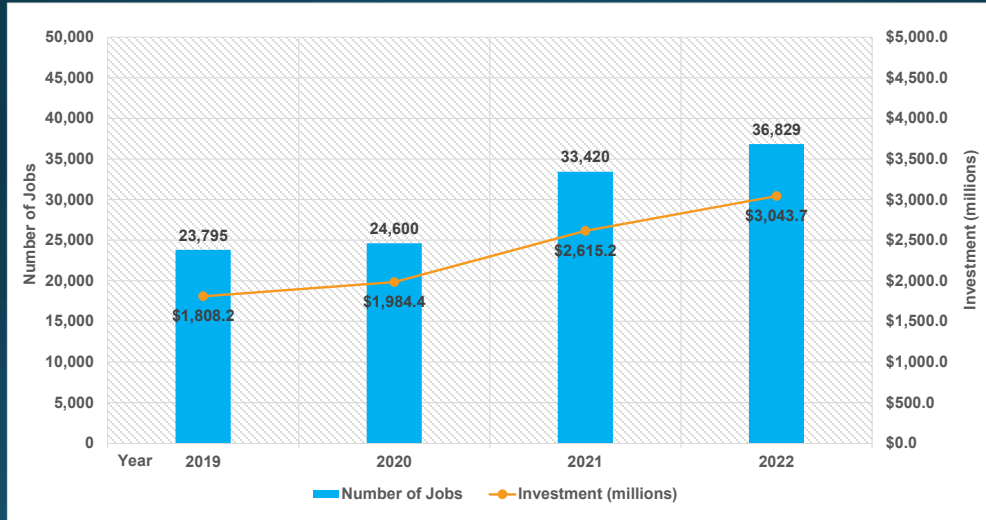

## Bay Region

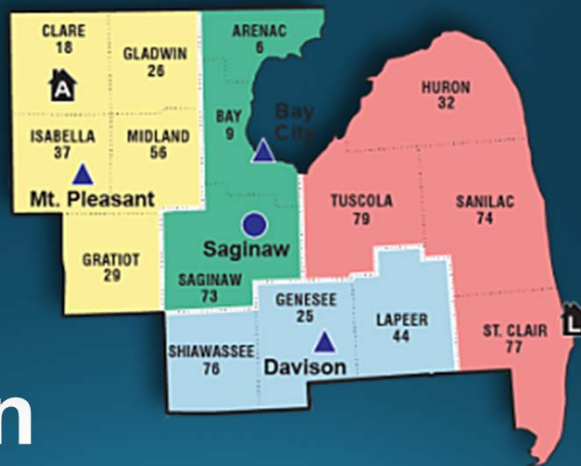



## I-69/I-475 in Flint

Concrete Reconstruction between  
Fenton Road and M-54 (Dort Hwy)  
Genesee County

**Bay Region, Davison TSC**

**Contractor:** Prime-Dan's Excavating

**Full CE Oversight:** Prime-Rowe

**Work Description:** 2.19 miles of freeway  
concrete road reconstruction with Rehabilitation of  
19 structures.

**Why It Matters:** RBMP, Good partnership with  
contractors a few innovative aspects

- Salvaging Shear Studs
- Low Carbon Chromium Reinforcement



## Grand Region



# Gun Lake Tribe Interchange Reconstruct & Upgrade US-131 at M-179 Allegan County

**Grand Region, Grand Rapids TSC**

**Contractor:** Kamminga and Roodvoets, Inc.

**Work Description:** \$20 Million construction of a Single Point Urban Interchange (SPUI) and HMA resurfacing along US-131 and M-179

**Why It Matters:** Non-traditional funding and project development process, completed in partnership with Gun Lake Tribe (GLT)



## Metro Region

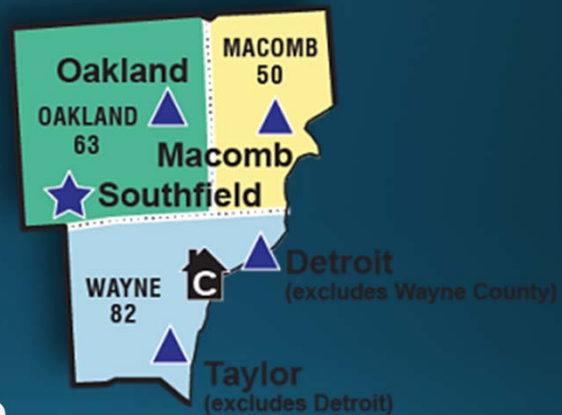

## I-75 Modernization, Segment 3 8 Mile to North of 13 Mile Oakland County

**Metro Region, Oakland TSC**

**Lead Contractor:** MI-75 Constructors LLC

**Work Description:** Reconstruct & widen 5.5 miles of Freeway, 28 road bridges or crossings

**Why It Matters:** Project will increase mobility, reduce congestion, address safety and drainage issues, and improve and guarantee bridge and pavement condition. First High-Occupancy Vehicle Lane (HOV)

Substantial completion August 31, 2023

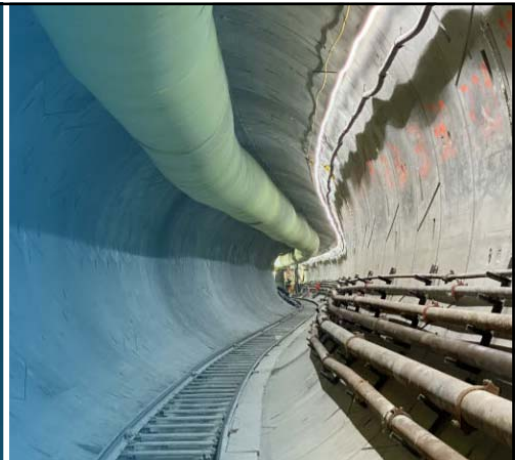

# North Region



## Mackinaw City I-75/US-23 Rebuilding Emmet & Cheboygan Counties

### North Region, Gaylord TSC

- **Contractor:** Anlaan Corporation
- **Work Description:** Rebuilding I-75 from old M-108 north to the Mackinac Bridge, and US-23 from I-75 to Huron Avenue. US-23 off-ramp overpass superstructure replacement
- **Why It Matters:** This \$12.7 million project rebuilt the two primary routes forming the gateway to the Upper Peninsula.



## Southwest Region

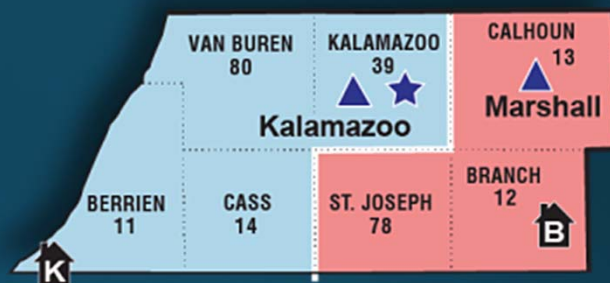

## US-31/I-94/I-94BL

### Completion of US-31 Freeway Berrien County

#### Southwest Region, Kalamazoo TSC

- **Contractor:** DJ McQuestion & Sons, Hardman Construction, J&N Construction LLC
- **Work Description:** US-31 New Freeway Construction, 7 miles of I-94 reconstruction and modernization, 3.5 modernization and right sizing of I-94BL
- **Why It Matters:** BUILD grant funding, Design/Build project delivery, US-31 is now a freeway-to-freeway connection with I-94 which provides for safer more efficient movement of goods and people.



## Superior Region

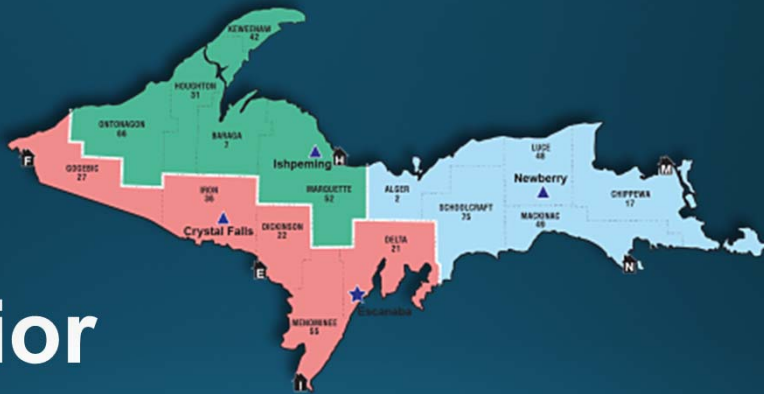

## US-41 City of Houghton MTU Campus to Downtown Houghton County

Superior Region, Ishpeming TSC

- **Contractor:** Bacco Construction Co.
- **Work Description:**
  - Reconstruction with lane reconfiguration and city water / sewer upgrades
  - Center left-turn lane along College Avenue
  - Four-to-two-lane conversion (with turn lanes) along Townsend Avenue
- **Why It Matters:**
  - Improved safety and mobility for pedestrians and motorists along a high-volume pedestrian corridor near Michigan Technological University (MTU)
  - Replaced deteriorating pavement
  - Partnerships with the City of Houghton and MTU were critical to the success of the project



## University Region





## I-69 from I-96 to Airport Road Clinton & Eaton Counties

### University Region, Lansing TSC

- **Contractor:** Michigan Paving and Materials Company
- **Work Description:** 5.2 miles of road reconstruction and preventive maintenance work on various bridges
- **Why It Matters:** Critical scour protection measures were completed on 3 structures over the Grand River



## 2023 Construction Program (Trunkline Only)

\*This information represents the total number of projects and dollars scheduled to be let in a given month. Therefore, the sum of values will not directly correlate to program year budgets, and this information is always subject to change.

Report Date: Jan. 3, 2023

Letting Month	Projects*	Construction Costs (\$ Millions)*
July, 2022	4	\$11.86
August, 2022	30	\$439.85
September, 2022	28	\$275.56
October, 2022	25	\$85.76
November, 2022	59	\$189.97
December, 2022	56	\$232.57
January, 2023	31	\$85.93
February, 2023	36	\$122.12
March, 2023	46	\$377.30
April, 2023	22	\$73.54
May, 2023	14	\$161.08
June, 2023	13	\$205.19
<b>Total</b>	<b>364</b>	<b>\$2,260.72</b>

# 2024 Construction Program (Trunkline Only)

\*This information represents the total number of projects and dollars scheduled to be let in a given month. Therefore, the sum of values will not directly correlate to program year budgets, and this information is always subject to change.

*Report Date: Jan. 3, 2023*

Letting Month	Projects*	Construction Costs (\$ Millions)*
July, 2022	3	\$59.36
August, 2022	45	\$331.69
September, 2022	31	\$393.19
October, 2022	32	\$264.49
November, 2022	22	\$143.43
December, 2022	53	\$329.59
January, 2023	7	\$87.03
February, 2023	8	\$52.81
March, 2023	12	\$15.86
April, 2023	8	\$8.77
May, 2023	1	\$3.07
June, 2023	1	\$0.06
<b>Total</b>	<b>223</b>	<b>\$1,689.34</b>

## Quantity Values

Item	2023	2024
<b>HMA (Tons)</b>	<b>4,184,981</b>	<b>1,559,522</b>
<b>Concrete (SYDs)</b>	<b>2,459,060</b>	<b>1,035,952</b>
<b>\$ of Bridge Work (Millions)</b>	<b>\$479.97</b>	<b>\$342.34</b>
<b>Aggregate (Tons)</b>	<b>150,511</b>	<b>130,029</b>
<b>Aggregate (SYDs)</b>	<b>2,774,155</b>	<b>1,436,643</b>
<b>Aggregate (CYDs)</b>	<b>753,042</b>	<b>384,126</b>
<b>Subbase (CYDs)</b>	<b>1,358,454</b>	<b>955,756</b>

*This information is draft and may change as the program is developed.*

# Balanced Lettings

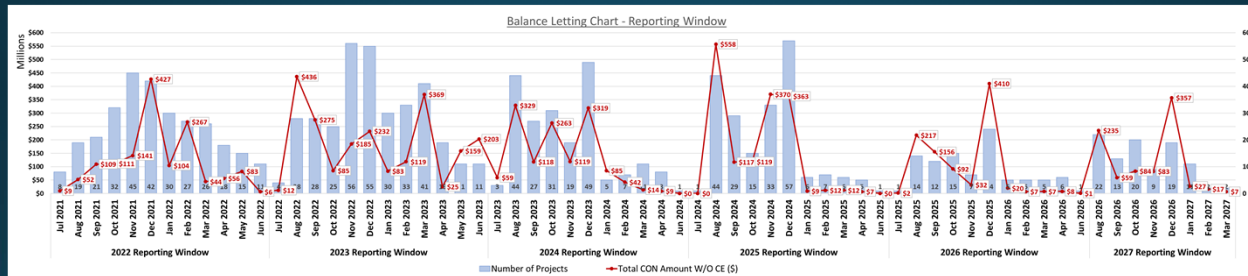

## April 2023 Bid Letting Pilot

As an effort to improve competition and competitive bidding, MDOT will be piloting two changes in the current project advertisement process:

- Will not be publishing the Eligible Bidders List
- Publishing a range of financial rating versus actual rating
  - Up to \$2M
  - Between \$2M and \$10M
  - Greater than \$10M

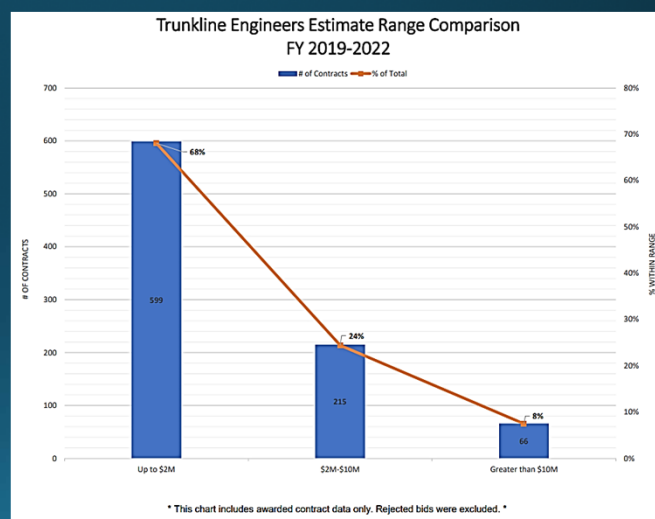





*Working together, MDOT and the heavy construction industry are advancing our culture and practices to put **SAFETY FIRST** in Michigan's work zones.*

## Automated Work Zone Enforcement Pilots

House Bill 5750 introduces the definition of an Automated Speed Enforcement System to MI Vehicle Code

Piloted Automated WZ Enforcement in 2 locations this summer

Supported by a joint effort of industry, MDOT and Michigan State Police



## Education via Work Zones 101-page

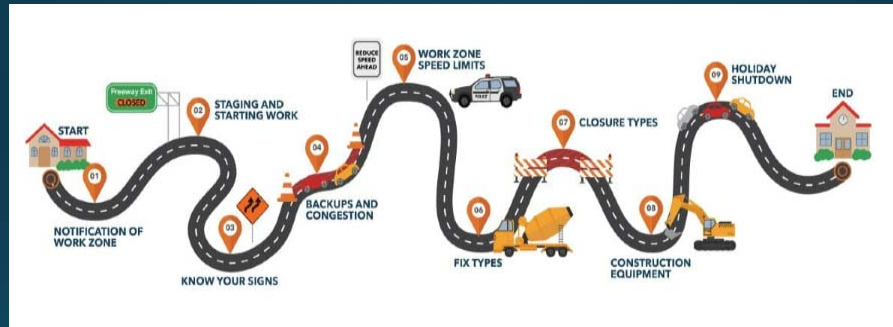

Users can take themselves on a self paced Intro to Work Zones.  
This includes knowing your signs, your equipment, the process,  
speed limits and closure types

## Safety Collaboration Special Provision

Previously approved Special  
Provision may be destined to be  
a Frequently Used Special  
Provision in 2024

Honors commitment to  
collaborate on necessary safety  
improvements

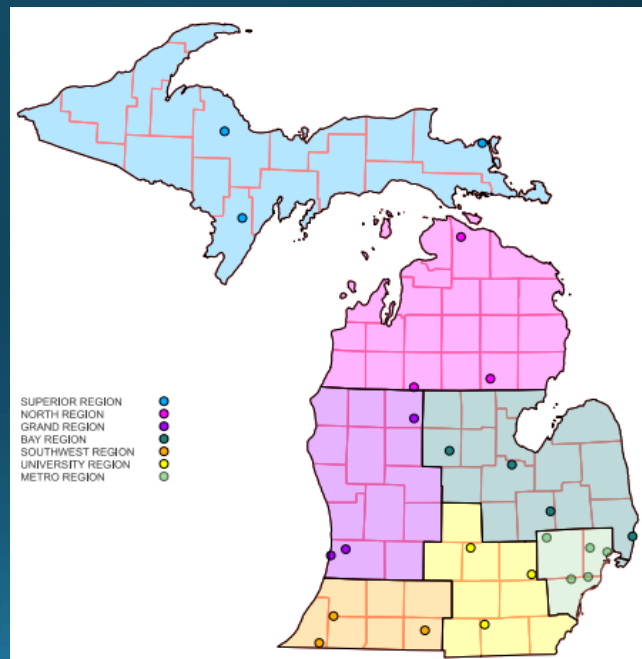



# The Infrastructure Investment and Jobs Act

27

## IIJA Funding Overview \$1.2 Trillion in Total Infrastructure Investment

\$550 Billion in new federal money

- **Road, Bridges, & Major Projects - \$110 Billion**
- Passenger and Freight Rail - \$66 Billion
- Power and Grid - \$65 Billion
- Broadband - \$65 Billion
- Water Infrastructure - \$55 Billion
- **Resiliency - \$47.2 Billion**
- Public Transit - \$39.2 Billion
- Airports - \$25 Billion
- Addressing Legacy Pollution - \$21 Billion
- Ports and Waterways - \$17 Billion
- **Safety - \$11 Billion**
- Western Water Infrastructure - \$8.3 Billion
- Clean School Buses and Ferries - \$7.5 Billion
- **Electric Vehicle Charging - \$7.5 Billion**
- **Reconnecting Communities - \$1 Billion**

*\* Sectors with new Highway Program Funding in Bold*

28



## Funding Available to a Range of Recipients

- Note:** This table does not include all IIJA programs or eligible entities, and there are additional nuances not represented in this table.
- \* "PA" means a special purpose district or public authority with a transportation function; FLMA means Federal Land Management Agency

Program Examples	State	MPO	Local	Tribe	PA*	Territory	FLMA*
Apportioned programs (formula)	✓						
Bridge Program (formula)	✓			✓			
National Electric Vehicle Formula Program	✓		✓				
Safe Streets and Roads for All program		✓	✓	✓			
PROTECT Grants (discretionary)	✓	✓	✓	✓	✓		✓
Charging and Fueling Infrastructure Program	✓	✓	✓	✓	✓	✓	
Congestion Relief Program	✓	✓	✓				
Bridge Investment Program (discretionary)	✓	✓	✓	✓	✓		✓
Reconnecting Communities Pilot Program	✓	✓	✓	✓			
Rural Surface Transportation Grants	✓		✓	✓			
INFRA	✓	✓	✓	✓	✓		✓
Nat'l Infra. Project Assistance	✓	✓	✓	✓	✓		
Local and Regional Project Assistance	✓	✓	✓	✓	✓	✓	

29

## Carbon Reduction Program Purpose



Reduce transportation emissions through the development of state carbon reduction strategies

Funding projects designed to reduce transportation emissions

30

# PROTECT

**P**romoting  
**R**esilient  
**O**perations for  
**T**ransformative,  
**E**fficient, and  
**C**ost-Saving  
**T**ransportation

## Enhance

Enhance the resiliency of infrastructure assets, including projects to improve the resilience of surface transportation assets and evacuation routes

## Ensure

Ensure continuity of operations and/or rapid recovery of communities where a natural disaster has occurred

## Utilize and Improve

Utilize and improve natural coastal infrastructure

31



